

STAIR DESIGN

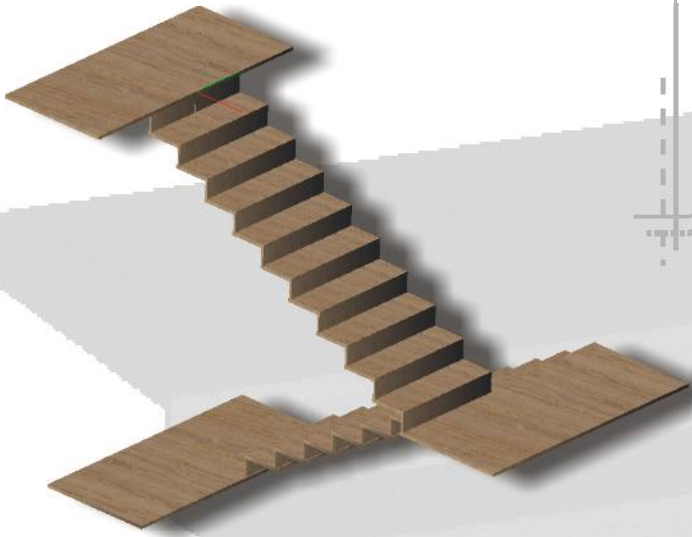

Scale is a complete stair design program. Stairs can be produced in a fully-automatic process, from the drawing to the cutting of the single parts.

A staircase can be “constructed” by taking predefined models and modifying all their characteristics according to requirements.

Each detail of a staircase is definable using the program: starting from the type of staircase (straight, curved, spiral...) and the volume of the environment in which it is to be installed, data are added defining the characteristics of the landings and steps.

Scale automatically generates the design, displaying plan and three-dimensional views of the drawing so each single detail can be modified at will.

The blueprint produced also contains all the data needed for its construction: the parts and automatic preparation of either box nesting or interlocking nesting for waterjet machines.

Machining and materials estimates, and drawings of the complete staircase and each single part can also be printed out.

The staircase can then be machined using the **Logotag** cad and **Magic Tool** cam software.

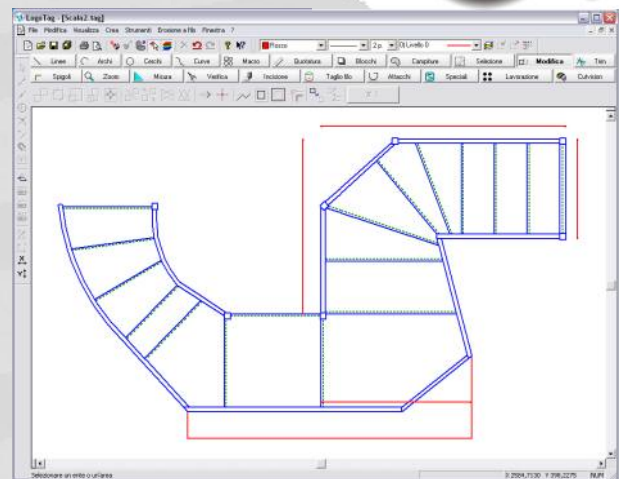
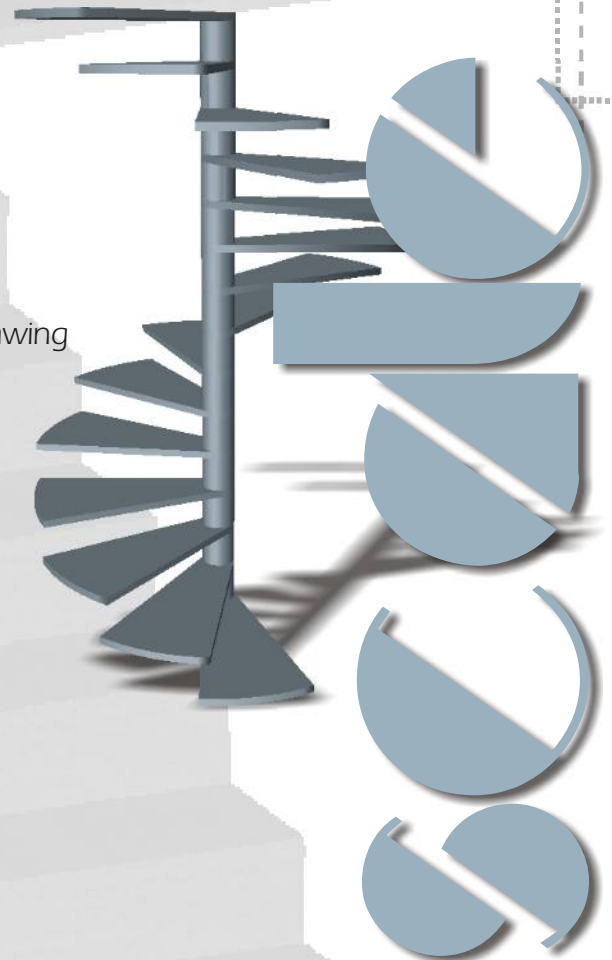

Automatic nesting

